

Reel TMR Mixers

REEL AUGGIE® / REEL COMMERCIAL

3100 / RA 100 Series / RC 200 Series



www.KuhnNorthAmerica.com



Invest in Quality®



REEL TMR MIXERS 3100 / RA 100 / RC 200

MAXIMIZE EFFICIENCY AND MIXING PERFORMANCE

LOWER FUEL CONSUMPTION

Quality performance with the lowest possible input costs is the goal of every operation. The fast, gentle mixing of KUHN Knight reel mixers helps maximize efficiency and minimize expense. The reel and auger design eliminates much of the force and pressure seen with other mixer types. The result is low horsepower requirements and less fuel consumption for a more economical operation.

ANNUAL FUEL SAVINGS

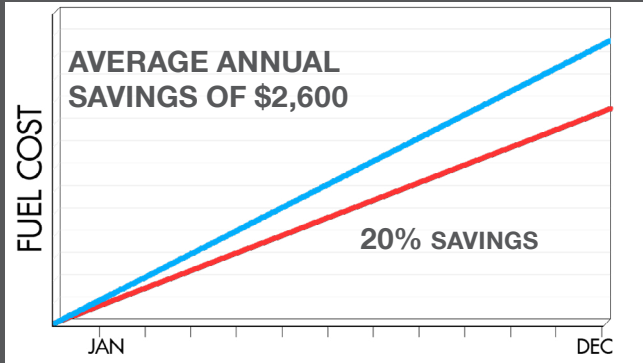

Fuel savings based on lower power requirement and shorter mix time compared to similar sized load in a vertical mixer. Estimated savings based on three hours of use per day using diesel fuel at \$2.50 per gallon. Actual savings may vary depending on application.

REEL MIXERS

Models	Mixing Capacity	Available Configurations
3115	150 cu. ft.	Trailer, Stationary
3120	220 cu. ft.	Trailer, Truck, Stationary
3125	250 cu. ft.	Trailer, Truck, Stationary
3130	300 cu. ft.	Trailer, Truck, Stationary
RA 136 Helix	360 cu. ft.	Trailer, Truck, Stationary
RA 142 Helix	420 cu. ft.	Trailer, Truck, Stationary
RC 250 Helix	500 cu. ft.	Trailer, Truck, Stationary
RC 260 Helix	600 cu. ft.	Trailer, Truck, Stationary
RC 270 Helix	700 cu. ft.	Trailer, Truck, Stationary
RC 295 Helix	950 cu. ft.	Trailer, Truck, Stationary

THE REEL ADVANTAGE

Reel mixers are ideal for dairy and beef producers mixing rations with high percentages of processed roughages or distillers grains. The reel thoroughly mixes rations gently without causing excessive damage to the feed ingredients, preserving precious nutritional value for your herd.

Reel mixers provide the ultimate versatility. From the popular, multi-purpose trailer models, to the fast, convenient transport offered by truck mounted machines, to stationary models that are ideal for central mixing, there is a mixer to meet the needs of any operation. These machines also offer a low standard loading height for easy loading with skid steers.

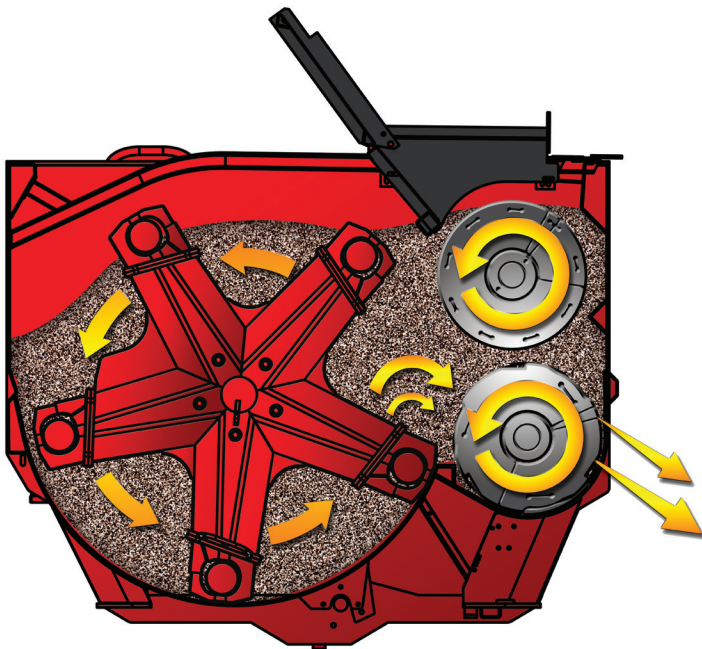

SUPERIOR FEED MOVEMENT

- The large reel gently lifts material up into the side augers for excellent side-to-side movement.
- The upper auger moves material rearward, while the lower auger moves material forward for end-to-end mixing. This helps feed continually charge the door during discharge.



CONSISTENT MIXING AND DISCHARGE

KUHN Knight reel mixers provide a consistent mix, even with small batches, for a balanced ration from beginning to end. Their quick, even discharge with a more complete cleanout helps save time and maximizes efficiency.



SIMPLE FEEDING

With a high discharge point, these mixers allow for the use of a simple slide tray in most feeding situations. The long tray makes it easy to feed deeper into most bunks, while preventing feed loss from the wind. This dependable, low-cost option also results in less maintenance.



THE ENHANCED REEL DESIGN

The Helix® reel has a robust build and has been thoroughly tested to withstand the most challenging conditions. The design of the reel crossbars evens the pressure across the length of the reel for smoother, more consistent operation. It also engages with the feed more smoothly.

OPEN CENTER REEL

The open-center design eliminates obstructions in the reel and provides superior feed movement and unparalleled mixing action. The benefits are unmistakable, with faster, more consistent mixing, improved load leveling, optimized mixer space utilization and fewer dead spots for the ultimate in ration quality.

SUPERIOR MIXING OF WET BY-PRODUCT RATIONS

A mix bar runs diagonally across the center of the reel to help ensure consistent feed movement throughout the entire mixing chamber. The reel crossbars keep feed moving efficiently around the outside of the chamber. The secondary mechanical mixing action from the mix bar provides a fast and thorough mix even in wet, heavy rations with large amounts of distillers grains.

IMPROVED LOAD LEVELING

With all potential obstacles removed from the center of the reel, feed is free to flow unobstructed from one end of the mixing chamber to the other. This greatly improves the end-to-end mixing action and helps eliminate uneven filling for optimum load leveling in any ration. Even leveling allows consistent use of the full capacity of the machine for maximum efficiency.

FASTER, MORE EVEN UNLOADING AND CLEANOUT

Cleanout speed is a key factor that can limit feeding efficiency, extending feeding cycles and ultimately costing valuable time and money. The open-center design provides fast, consistent unloading, with quicker, more complete cleanout than competitive models. The result is optimum performance, allowing the operator to move on to the next batch faster.

ENHANCED PERFORMANCE FOR GRAIN AND ROUGHAGE RATIONS

The cutting-edge design has been extensively tested with the toughest beef and dairy rations. The results are clear, from dry, dusty materials, to wet, heavy rations, the Reel Auggie® mixers with Helix® reel technology set a standard for quality performance and superior mixing to meet the needs of even the most demanding producers.

TIME-TESTED DESIGN

KUHN Knight 3100 Series Reel Auggie® mixers offer the same quality mixing performance and dependable service that has been their hallmark. The time tested, standard reel and auger design provides a fast, thorough mix for a fluffy, palatable ration. Quality components and a rugged design help ensure reliability and long life. These mixers are available in trailer, truck and stationary models with capacities ranging from 150 to 300 cubic feet.

Note: The 3115 is not available as a truck-mounted model



STANDARD REEL AND AUGER DESIGN

The large-diameter reel works together with the side-blending augers to produce an end-to-end and side-to-side mixing action for a consistent ration, even with small batches. This unique combination ensures fast mixing and unloading to save time and maximize efficiency.

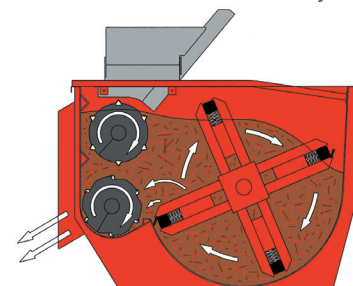

OUTSTANDING RELIABILITY & PERFORMANCE

The KUHN Knight RA 100 Series Reel Auggie® mixers provide outstanding durability and performance, with advanced features that stand out from the competition. The Helix® reel, with its open-concept design, offers faster, more consistent mixing and improved load leveling with any ration. Strengthened body and drive components provide superior dependability and long life. These mixers are available in trailer, truck and stationary models with capacities of 360 and 420 cubic feet.



BOLTED AUGER FLANGES

Bolted flanges on the upper and lower augers provide strong connections between the auger tubes and drive shafts for superior durability. They also allow for a single-piece front panel that gives added strength and provides a clean look.

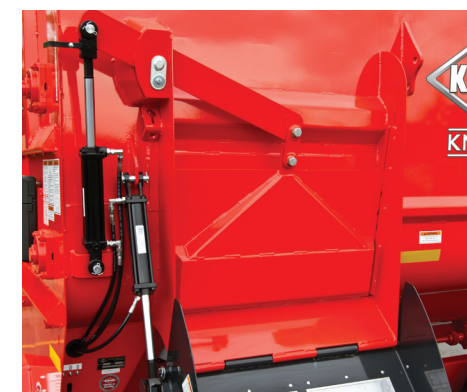

HEAVY-DUTY DISCHARGE DOOR

The door discharge and pivot have been redesigned and strengthened for extended service life. The linkage incorporates two ball pivots for smooth operation.



UPGRADED REAR DRIVE SHAFT

A heavy, 1 1/2" rear drive shaft provides added strength for dependable service, even in rations heavy in distillers grains.



EASY ACCESS DOOR

The new single-handled latch provides easy access to the oil bath. An improved seal keeps oil in, and dirt and debris out, to help minimize wear on drive components and maintain a cleaner appearance.

OUTPERFORM EXPECTATIONS

KUHN Knight RC 200 Series Reel Commercial mixers provide superior durability and performance with innovative options that separate them from the competition. The Helix® reel, with its open-center design, offers fast, consistent mixing and superior load leveling with any ration. The enhanced reel design optimizes the mixing of wet by-product rations, but through extensive testing has proven to provide quality performance in all rations. The heavy-duty drive option offers extended life, in even the most extreme use cycles, and provides the ability to mix the heaviest feedstuffs. These features, combined with the versatility and low horsepower requirements that are the hallmark of the reel and auger design, put these RC models at the head of their class! With truck, trailer and stationary models, and capacities ranging from 500 to 950 cubic feet, there's a machine to fit every feeding situation.

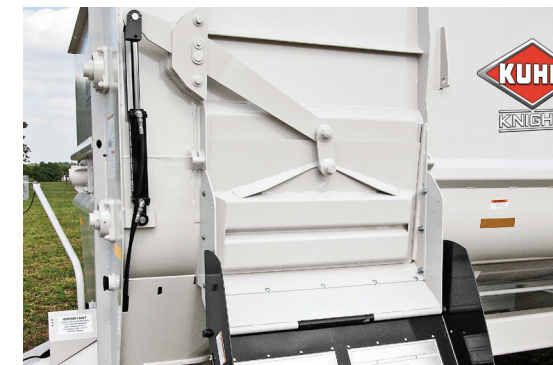

SLIDE TRAY LINKAGE

The discharge door and linkage have been reinforced to provide reliable service and long life. The slide tray linkage has also been relocated and improved. This change provides increased adjustability to adapt to different feeding situations and eliminates the possibility of the tray extending over center when opened.



RUGGED UNDERCARRIAGE OPTIONS

Straight-single and walking-tandem bogie axle options are available for trailer models, providing flexibility for varied terrain. Both feature heavy-duty spindles and hubs for maximum durability and long life.



STANDARD OR LOWERED RIGHT SIDE

The option of a standard or lowered right side allows customers the flexibility to choose the setup that best matches the needs of their operation.

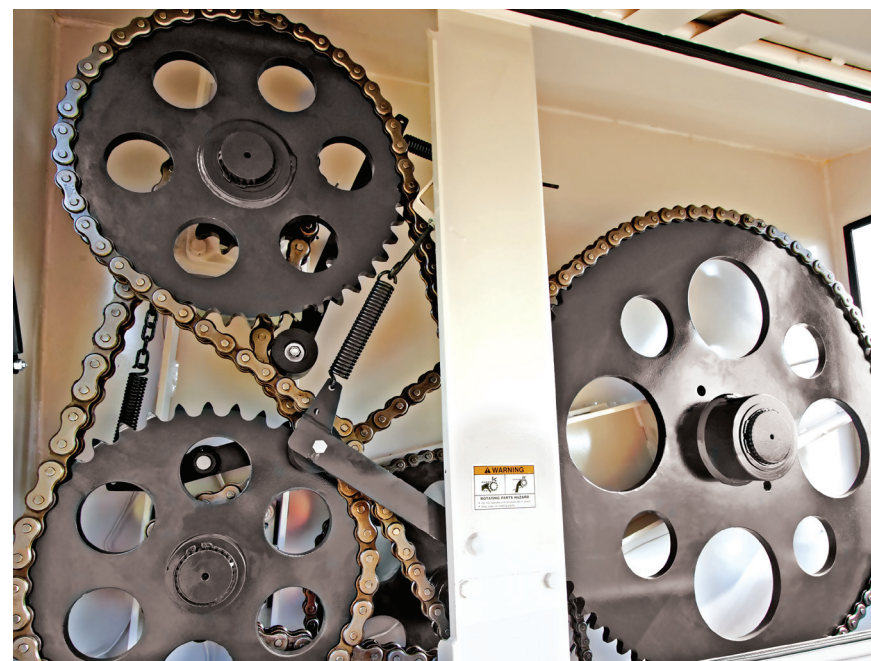

HD DRIVE

A heavy-duty drive provides heavier chains throughout and a larger diameter countershaft and bearings for added strength and extended life in the toughest mixing conditions and heaviest use cycles. *Optional on RC 250 & 260*

The splined drive shafts allow a strong, reliable torque transfer and provide easier sprocket alignment and maintenance.

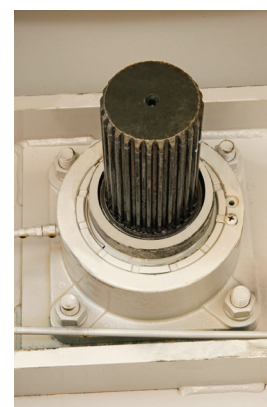

TAILOR YOUR MACHINE TO MEET YOUR RATION'S NEEDS

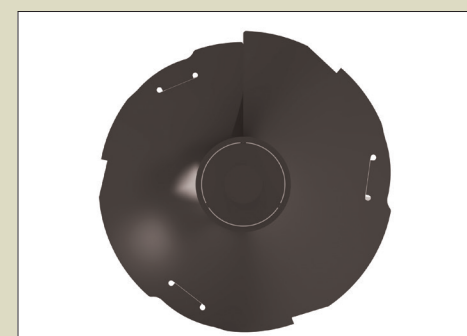

GRAIN-AUGER

The grain-auger option provides gentle handling of more delicate feeds like flaked corn to maintain ration quality and prevent fines.

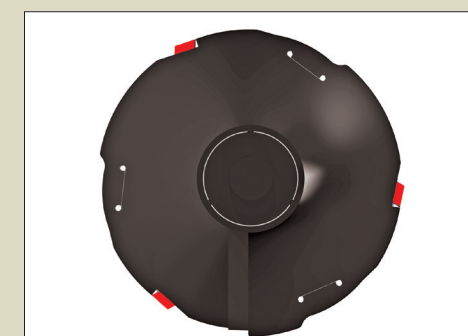

ROUGHAGE-AUGER

The roughage-auger option features notched, sectional fighting with welded-in, self-sharpening, hardened knives for better hay handling.

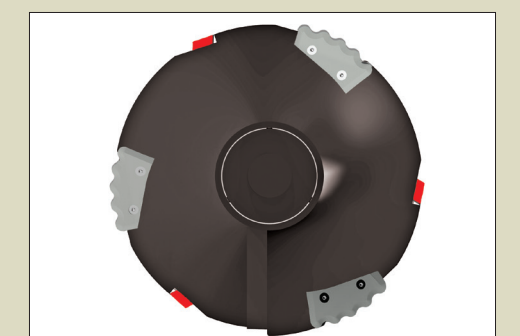

ROUGHAGE MAXX®

With the Roughage Maxx System, scalloped knives are added to the lower augers to maximize hay processing. The knives provide a more consistent particle length and more even blending of the ration.

MAXIMIZE FEEDING EFFICIENCY

Whether mixing wood chips or a ration for your livestock, KUHN Knight reel mixers are available in a stationary configuration and are ideal for maximizing feeding efficiency and mixer throughput on any operation. Stationary mixers are perfect for producers with centralized feed storage and multiple mixers running throughout the day. By incorporating centralized mixing, one loader operator is often able to keep multiple mixers constantly running, greatly increasing mixing capacity and reducing labor. Also, with the addition of delivery boxes, the mixers do not experience the downtime from driving location to location, and in turn do not receive the additional stress which can be seen from constant travel.

STATIONARY MIXERS:

- ✓ Allow for use of a delivery box that can deliver feed more efficiently, especially with longer travel distances
- ✓ Decrease cycle time since feed can continue to mix while the delivery truck is delivering feed to your livestock
- ✓ Minimize stress seen from constant travel



TRUCK MOUNT OPTIONS

Kuhn North America offers complete factory mounting of mixer to truck chassis. In addition, we are able to alter customer supplied truck chassis to fit your specific feeding needs through modifications in our truck shop.



DRIVE SELECTION FOR MAXIMUM PERFORMANCE

MECHANICAL DRIVE

Due to the low horsepower requirement of the reel auger design, a mechanical drive powered by a transmission PTO works well in many feeding situations, at a lower cost than alternative drive options. Mechanical drives are available in a number of different configurations, including front and mid-unit gearbox mounting in order to match up to nearly any truck chassis.

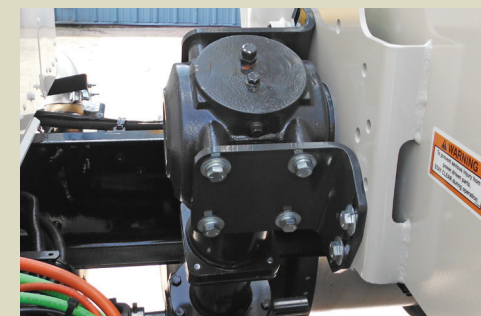

HYDROSTATIC DRIVE

In addition to mechanical drives, the RC 200 Series is also available with a hydrostatic drive. This hydrostatic system is driven off of either a front engine (FEPTO) or rear engine (REPTO) power take-off. Driven off of the engine instead of transmission, hydrostatic drives allow for the mixer speed to be controlled independent of ground speed. The hydrostatic drives also allow for gentler mixer startup, which is especially important in larger units mixing heavier loads.

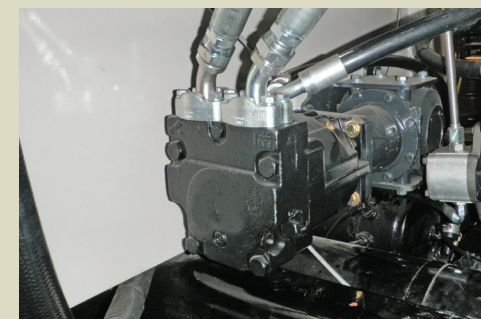

Customized to Fit Your Operation

MULTIPLE DISCHARGE OPTIONS



SLIDE TRAY

The high discharge point of Reel Auggie mixers allows use of the simple, dependable, low-cost slide tray in most applications. It has simple hydraulic controls and the long discharge tray reaches deeper into bunks to prevent feed loss from the wind. Magnets are standard on slide tray.

Available on all models



CHAIN AND SLAT CONVEYOR

Rugged chain and slat conveyor options provide the ultimate in durability and long life. Heavy-duty components ensure reliable service and multiple conveyor length options offer unmatched flexibility to match different feeding situations.

Available on all models except RC 295

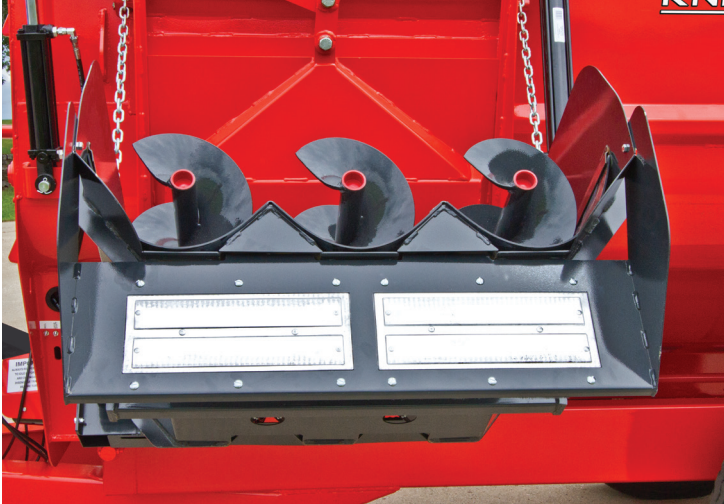

3-AUGER DISCHARGE

The 3-auger discharge allows adjustment for feeding into higher bunks. It has a simple, hydraulic drive that provides smooth, even discharge. Long lasting, poly chute liners help prevent rust and limit wear. The 3-auger discharge comes standard with fixed tip-off and built-in magnets.

3100 and RA models only

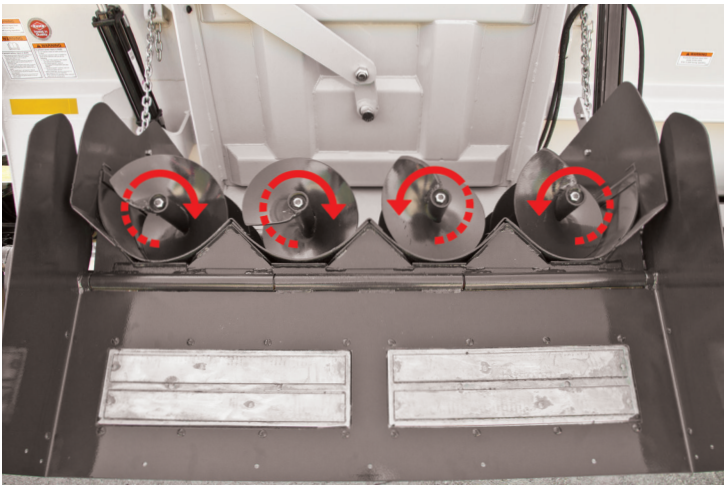

4-AUGER DISCHARGE

Counter-rotating augers bring the feed to the center of the discharge to increase overall capacity and provide a smooth, even discharge for all ration types. The 4-auger discharge comes standard with power tip-off and built-in magnets.

RC 250, 260 & 270 models only



REMOVABLE AUGERS & POLY LINERS

The discharge augers are held on by a single lock nut making them firmly attached, yet simple to remove for easy cleaning and service. Long-lasting, replaceable polyethylene chute liners prevent rust and limit wear.

4-auger discharge feature

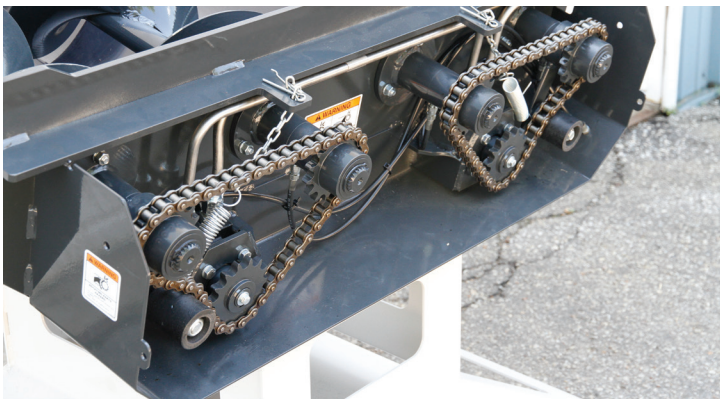

SIMPLIFIED DRIVE

As with the main auger drive, the discharge auger shafts are splined for a more positive power transfer and longer service life. The simplified drive design, featuring only two chains and a remote grease bank, results in easy service and maintenance.

4-auger discharge feature

EFFECTIVE HAY HANDLING



ROUGHAGE MAXX®

With the Roughage Maxx System, scalloped knives are added to the lower auger to maximize hay processing. The knives provide a more consistent particle length and more even blending of the ration. The result is a more uniform and palatable ration with reduced sorting for overall better feed efficiency.



HAY MAXX®

The Hay Maxx System provides enhanced processing of a wide variety of materials. Hay and other bulky materials can be placed on the pan, allowing them to be preprocessed by the upper auger before entering the mixing chamber. Additional aggressive, hardened-edge knives are added to the upper auger that help process the hay to the proper length before entering the mixing chamber.

ADDITIONAL OPTIONS



SCALE SYSTEMS

Different scale brands, models and options are available for all types of operations, ranging from the basic to high-end feed tracking programs. Optional remote indicators are available for placement that will allow easier viewing.

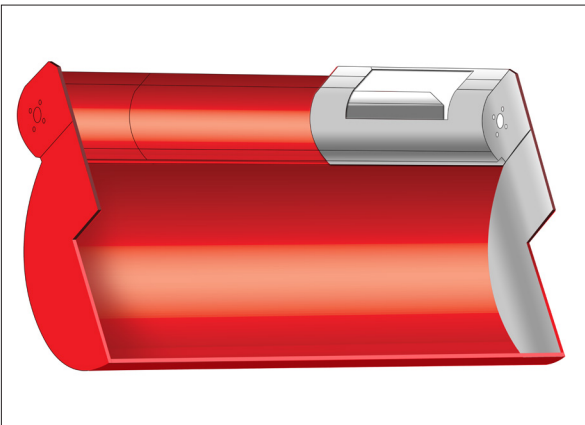

PARTIAL OR FULL STAINLESS STEEL LINER

The partial liner covers the most critical wear areas in the mixer and provides added protection and longer life. The full liner completely covers all of the high-wear areas for unmatched dependability and long service. Both provide added protection when mixing more abrasive or corrosive materials resulting in longer life of the unit shell.

STATIONARY MODELS

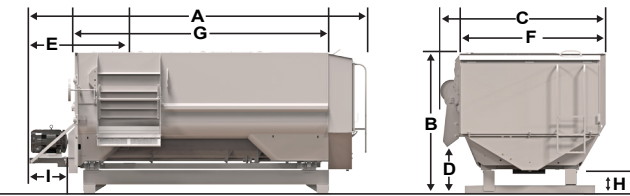

Model Specifications										
	3115	3120	3125	3130	RA 136	RA 142	RC 250	RC 260	RC 270	RC 295
DIMENSIONS	Stationary	Stationary	Stationary	Stationary	Stationary	Stationary	Stationary	Stationary	Stationary	Stationary
A – Overall Length ¹ (+Motor Mount)	113"	159"	160"	184"	184"	208"	226"	256"	286"	309"
B – Overall Height (+Rails and Scales)	64"		69"		87"		84"		95"	
C – Overall Width (+ Magnet Tray)	87"	95"	97"		108"		114"		125"	
D – Discharge Height (+Rails and Scales)	16 ½"	18"	19"		23"		26"		23"	
E – Motor Mount to Center Door	50"	65"	66"		60"		70"		–	
F – Overall Width Top Opening	71"	78"	81 ½"		87"		93"		108"	
G – Overall Length Top Opening	82"	120"		144"	132"	156"	168"	198"	228"	216"
H – Height Reduction (Less Rails/Scales)	7"		6 ½"		14"		5 ½"		–	
I – Length Reduction (Less Motor Mount)	12"	23"		28"		36"		–		–
SPECIFICATIONS										
Unit Weight ² – Helix Reel	–				9,310 lbs	9,720 lbs	15,325 lbs	16,400 lbs	19,270 lbs	23,320 lbs
Unit Weight ² – Standard Reel	2,850 lbs	4,809 lbs	6,489 lbs	7,021 lbs	–		–		–	
Mixing Capacity (Cubic Foot/Bushels)	150 / 118	220 / 174	250 / 200	300 / 240	360 / 288	420 / 338	500 / 415	600 / 490	700 / 562	950 / 763
Reel										
– Diameter	52"		60"		68"		70"		84"	
– Arms	4				Helix Reel: 5		Helix Reel: 5			
Door Opening Size	20" X 16"		36" X 20"		36" X 20"		42" X 22"		48" X 26"	
Roller Chain Drive										
– Standard	60-80-100	60H-80H-100H			80-100-120		80-100-120-140		100-120-140-140	100-140-160-200
– Optional Heavy-Duty	–				–		100-120-140-140		HD Standard	
Electric Drive ³	7 ½ – 10 hp	10 hp		10 – 15 hp	15 – 30 hp		50 hp	60 hp	70 hp	100 hp

¹ RC 295 motor mounts on the floor and dimensions include motor, 18" driveline and gearbox. ² Unit is equipped with most common options. ³ Horsepower requirement may vary with different materials. Consult operator's manual for proper motor sizing.



TRAILER & TRUCK MODELS

Model Specifications

	3115		3120		3125		3130		RA 136		RA 142		RC 250		RC 260		RC 270		RC 295	
DIMENSIONS	Trailer		Trailer	Truck	Trailer	Truck	Trailer	Truck	Trailer	Truck	Trailer	Truck	Trailer	Truck	Trailer	Truck	Trailer	Truck	Trailer	Truck
A – Overall Length	145"		189"	150"	189"	146"	213"	170"	209"	158"	233"	182"	242"	189"	272"	219"	302"	249"	294"	247"
B – Mixing Chamber Length	84"		120"		120"		144"		132"	132"	156"	156"	168"		198"		228"		216"	
C – Front Discharge to Bumper	78"		115"	–	115"	–	139"	–	143"	142"	168"	167"	182"	180"	212"	210"	242"	240"	231"	232"
D – Overall Height Standard ^{1,2}	77"		84"	102"	88"	106"	88"	106"	103"/97"	115"	103"/97"	115"	107"	120"	107"	120"	107"	120"	126"	135"
E – Lowered Right Side Reduction	–		–		–		–		15"	15"	15"		12"		12"		12"		–	
F – Tread Width: ² Single Axle/Tandem Axle	82" / NA		82" / NA	–	84" / NA	–	84" / NA	–	94" / NA	96"	94" / NA	96"	101"/113"	96"	101"/113"	96"	101"/113"	96"	NA /110"	96"
G – Overall Width (Mixer Only)	88"		88"		94"		94"		99"	99"	99"		102"		102"		102"		120"	
H – Slide Tray: Maximum Reach	20"		22"	13"	25"	16"	25"	16"	21"	20"	21"	20"	22"		22"		22"		30"	
– 3-Auger Discharge: Max Reach – 24"/36"	–		41"/47"	20"/30"	40"/46"	23"/33"	40"/46"	23"/33"	30"/40"	30"/40"	30"/40"		–		–		–		–	
– 4-Auger Discharge: Max Reach – 28"/36"/45"	–		–		–		–		–	–	–		29"/36"/43"	–	29"/36"/43"	–	29"/36"/43"	–	–	
– Chain & Slat: Max Reach – 24"/36"/48"/72"	–		–		–		–		30"/40"/50"/NA	30"/40"/50"/NA	30"/40"/50"/NA		30"/40"/49"/69"	–	30"/40"/49"/69"	–	30"/40"/49"/69"	–	–	
I – Slide Tray: Maximum Height	19"		26"	44"	25"	43"	25"	43"	35"	48"	35"	48"	35"	48"	35"	48"	35"	48"	50"	59"
– 3-Auger: Max Height – 24"/36"	–		41"/47"	59"/65"	40"/46"	58"/64"	40"/46"	58"/64"	50"/56"	63"/69"	50"/56"	63"/69"	–		–		–		–	
– 4-Auger Discharge: Max Height – 28"/36"/45"	–		–		–		–		–	–	–		51"/56"/61"	–	51"/56"/61"	–	51"/56"/61"	–	–	
– Chain & Slat: Max Height – 24"/36"/48"/72"	–		–		–		–		–	–	–		53"/60"/67"/81"	–	53"/60"/67"/81"	–	53"/60"/67"/81"	–	–	
J – Slide Tray: Transport Width	99"		97"		101"		101"		106"	110"	106"	110"	114"		114"		114"		128"	
– 3-Auger: Transport Width: 24"/36"	–		108"/112"	114"/118"	114"/118"	122"/126"	122"/126"		–	–	–		–		–		–		–	
– 4-Auger Discharge: Transport Width – 28"/36"/45"	–		–		–		–		–	–	–		124"/125"/125"	–	124"/125"/125"	–	124"/125"/125"	–	–	
– Chain & Slat: Transport Width – 24"/36"/48"/72"	–		–		–		–		–	–	–		120"/122"/123"/125"	–	120"/122"/123"/125"	–	120"/122"/123"/125"	–	–	
K – Hinge Height for Discharge																				
– Standard	31"		36"	53"	37"	53"	37"	53"	48"	61"	48"	61"	47"	56"	47"	56"	47"	56"	56"	65"
– Riser Kit	37"		42"	–	43"	–	43"	–	–	–	–		–		–		–		–	
L – Height: Haypan Up	17"		22"	25"	22"	25"	22"	25"	23"	23"	23"		22"		22"		22"		22"	
M – Height: Haypan Down	–		8"	11"	8"	11"	8"	11"	8"	8"	8"		8"		8"		8"		8"	
N – Length: Haypan	84"		96"		96"		96"		96"	96"	120"		120"		144"		144"		144"	
SPECIFICATIONS																				
Unit Weight ³ – Standard Reel	3,720 lbs		6,173 lbs	4,810 lbs	7,771 lbs	6,489 lbs	8,562 lbs	7,021 lbs	–	–	–		–		–		–		–	
Unit Weight ³ – Helix Reel	–		–		–		–		10,390 lbs	9,300 lbs	11,250 lbs	9,710 lbs	16,000 lbs	14,950 lbs	17,200 lbs	16,090 lbs	21,000 lbs	18,820 lbs	25,300 lbs	20,250 lbs
Maximum Net Load	4,410 lbs		6,480 lbs		7,500 lbs		9,000 lbs		10,800 lbs	10,800 lbs	12,600 lbs		15,000 lbs		18,000 lbs		21,000 lbs		28,500 lbs	
Mixing Capacity (Cubic Foot/Bushels)	150/118		220/174		250/200		300/240		360/288	360/288	420/338		500/402		600/482		700/562		950/763	
Reel																				
– Diameter	52"		52"		60"		60"		68"	68"	68"		70"		70		70"		84"	
– Arms	4		4		4		4		Helix Reel: 5	Helix Reel: 5	Helix Reel: 5		Helix Reel: 5		Helix Reel: 5		Helix Reel: 5		Helix Reel: 5	
Auger Hopper Thickness	¼"		¼"		⅜"		⅜"		⅜"	⅜"	⅜"		⅜"		⅜"		⅜"		⅜"	
Side Sheets Thickness (Auger/Reel)	10 GA		10 GA		10 GA		10 GA		10 GA / ⅜"	10 GA / ⅜"	10 GA / ⅜"		¼"		¼"		¼"		¼"	
End Sheets Thickness	10 GA		10 GA		⅜"		⅜"		⅜"	⅜"	⅜"		¼"		¼"		¼"		¼"	
Door Opening Size	20"x16"		36"x20"		36"x20"		36"x20"		36"x20"	36"x20"	36"x20"		42" x 22"		42" x 22"		42" x 22"		48" x 26"	
Roller Chain Drive																				
– Standard	60-80-100		60H-80-100H		60H-80H-100H		60H-80H-100H		80-100-120	80-100-120	80-100-120		80-100-120-140		80-100-120-140		80-100-120-140		100-140-160-200	
– Optional Heavy-Duty	–		–		–		–		–	–	–		100-120-140-140		100-120-140-140		100-120-140-140		HD Standard	
Spindle Diameter: Single Axle/Tandem Axle	2 ½" / NA		2 ½" / NA		3" / NA		3" / NA		3 ⅜"	–	3 ⅜"	–	4 ½" / NA	–	4 ½" / 3 ⅜"	–	4 ½" / 3 ⅜"	–	NA / 4 ½"	–
Hub	8-Bolt		8-Bolt		8-Bolt		8-Bolt		10-Bolt	–	10-Bolt	–	HD 10-bolt	–	HD 10-bolt	–	HD 10-bolt	–	HD 10-bolt	–
Tongue Weight: % Gross Weight	18%		12%		14%		14%		12%	–	9%	–	9%	–	11%	–	10%	–	11.5%	–
Tractor Requirement: PTO ⁴	45 hp		50 hp	–	55 hp	–	60 hp	–	75 hp	–	90 hp	–	100 hp	–	110 hp	–	120 hp	–	165 hp	–

¹ Truck dimensions based on 41" truck frame height. ² Heights and widths will vary depending on tire size. ³ Unit is equipped with most common options. ⁴ Horsepower requirement may vary with different materials. Consult operator's manual for proper tractor sizing.



REEL TMR MIXERS 3100 / RA 100 / RC 200

A KUHN KNIGHT MIXER FOR EVERY OPERATION



Most complete TMR mixer line on the market



1. Single-auger vertical TMR mixers / 2. Twin-auger vertical TMR mixers / 3. Triple-auger vertical TMR mixers / 4. 4-auger horizontal TMR mixers

For more information about your nearest KUHN Knight dealer and other KUHN Knight products, visit our website

www.KuhnNorthAmerica.com



Visit our YouTube channel to watch our latest product videos.



www.KuhnNorthAmerica.com

Your KUHN Knight dealer

KUHN NORTH AMERICA, INC.

Corporate Headquarters

1501 West Seventh Avenue - Brodhead, WI 53520

Information given in this document is only for informational purposes and is non-contractual. Our machines are in compliance with North American safety standards. In our literature, and for improved illustration of certain details, some safety devices may not be in operating position. When operating these machines, these devices must be operated in accordance with the requirements indicated in the operator's manuals and assembly manuals. We reserve the right to change any designs, specifications or materials listed without further notice. Machines and equipment in this document can be covered by at least one patent and/or registered design. Trademarks cited in this document may be registered in one or several countries.

Find us on

